

4

3

2

1

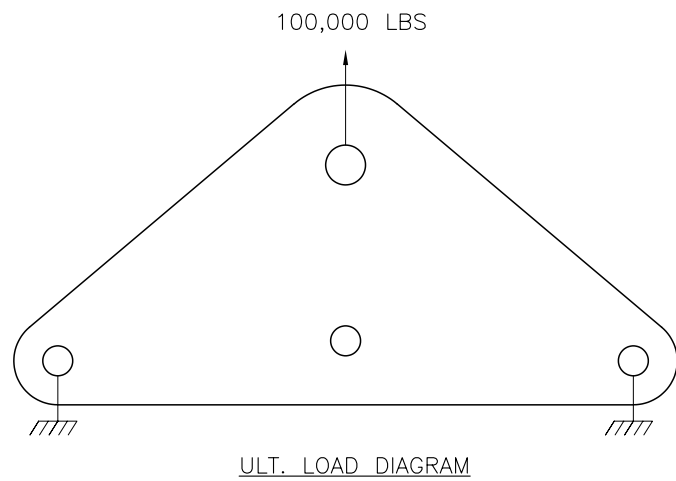

B

B

A

A

A

A

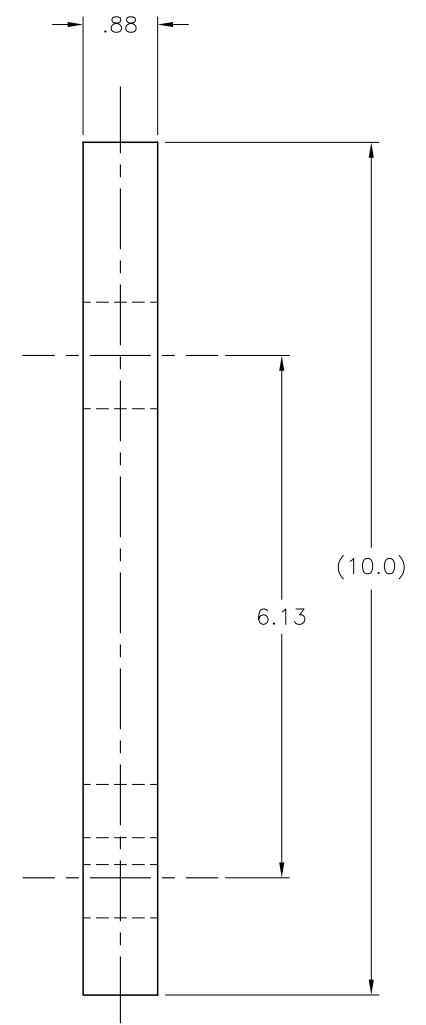
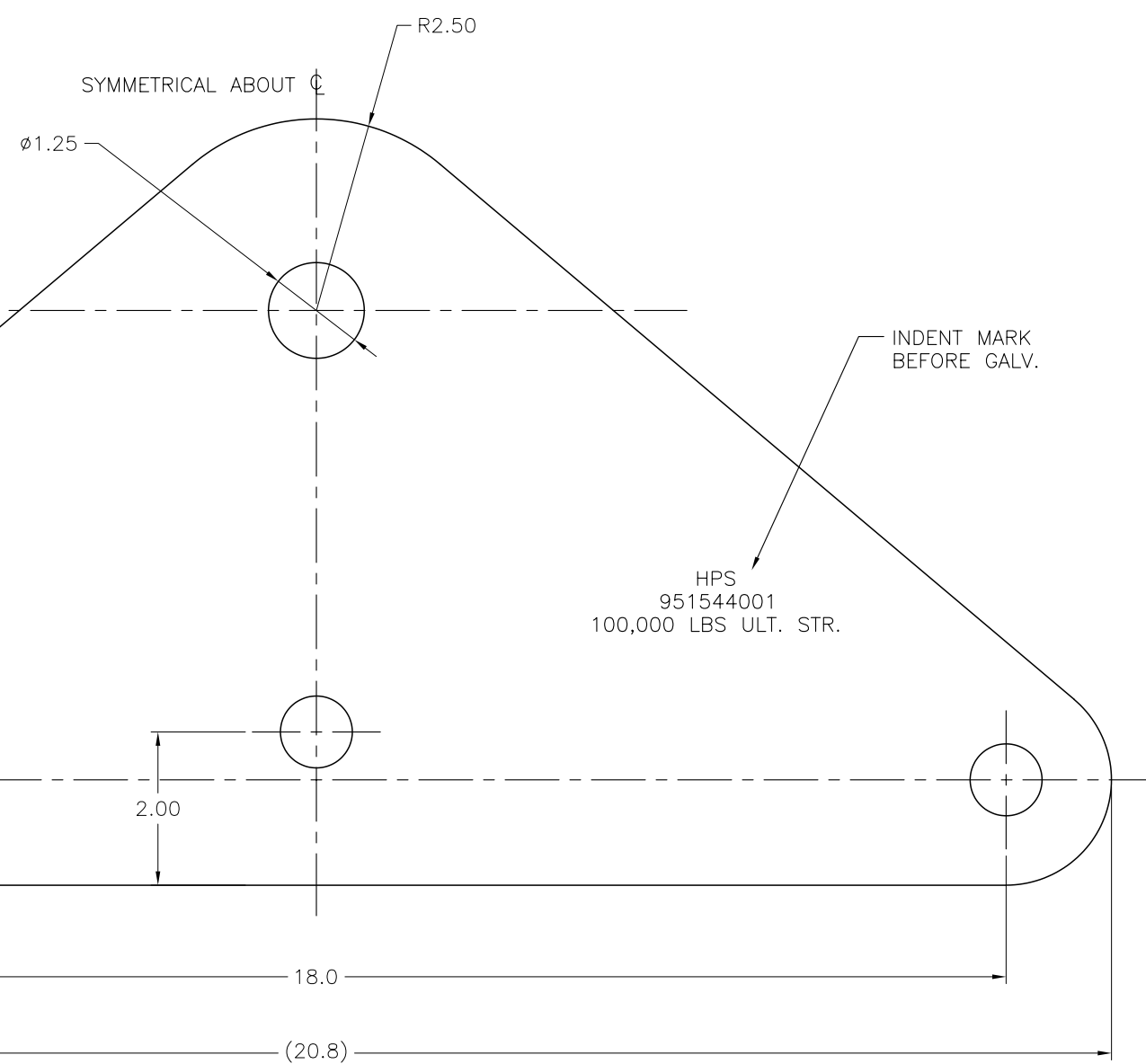

NOTES:

- 1. MATERIAL: GALV. STEEL.
- 2. HOT DIP GALVANIZED PER ASTM A153.
- 3. ANY COLD WORKING MUST BE AS PER ASTM A143.
- 4. BREAK ALL SHARP EDGES AND DEBURR ALL HOLES.
- 5. WEIGHT: 31.64 LBS APPROX.
- 6. DIMENSIONS IN INCHES.

--	--	--	DL	DTB
EC #	DATE	CHG BY	CKD BY	APPD BY
DESC OF DWG: DRAWING CREATED IN AUTOCAD				
--				
<u>PRELIMINARY ONLY</u>				
--				
REASON (S) FOR CHANGE: --				
DISPOSITION OF MAT'L: --				

THIRD ANGLE PROJECTION

CONFIDENTIAL: THIS DRAWING AND ITS CONTENTS ARE CONFIDENTIAL AND THE EXCLUSIVE PROPERTY OF HUBBELL POWER SYSTEMS. NO PUBLICATION, DISTRIBUTION, OR COPIES MAY BE MADE WITHOUT THE WRITTEN CONSENT OF HUBBELL POWER SYSTEMS. HUBBELL POWER SYSTEMS UNPUBLISHED ALL RIGHTS RESERVED UNDER THE COPYRIGHT LAWS.

**HUBBELL** POWER SYSTEMS, Inc.

TITLE: YOKER PLATE  
100K LBS ULT. STR.

CATALOG NUMBER: 951544001

SIZE: B	DWG NO.: CUTSHEET	PART / ASSY NO.: --	REV: A
SCALE: NS	DRN BY: SV	DATE: 09/04/20	SHEET 1 OF 1

4

3

2